

# I-PARENT

## ONLINE ENROLLMENT FOR OLD STUDENT

**STEP 1: Go to the URL provided by the school, click the Parent Tab then click Create Account.**

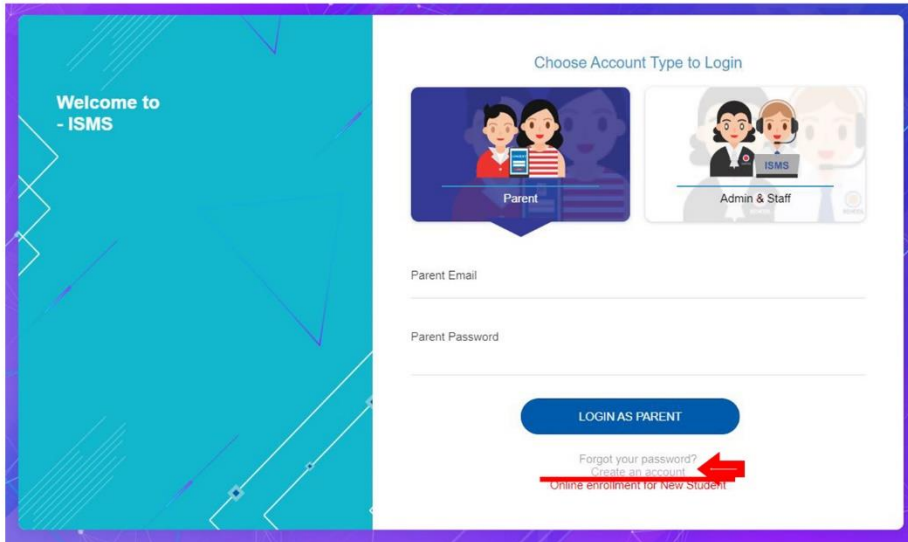

**STEP 2: Click Create an Account and provide data as accurately as possible.**  
**\*\*Min. of 8 characters and case-sensitive**

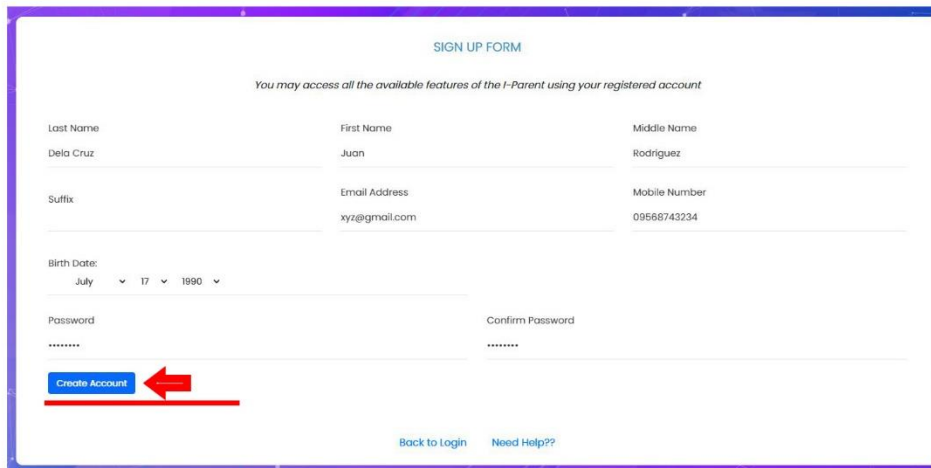

**\*\*\*Please use your email that you registered in the Registrar's Office.**

**Should you happen to forget the registered email, please call the school for verification.**

**STEP 3: Open your email and check your **Inbox, Spam or Promotions Tab.****

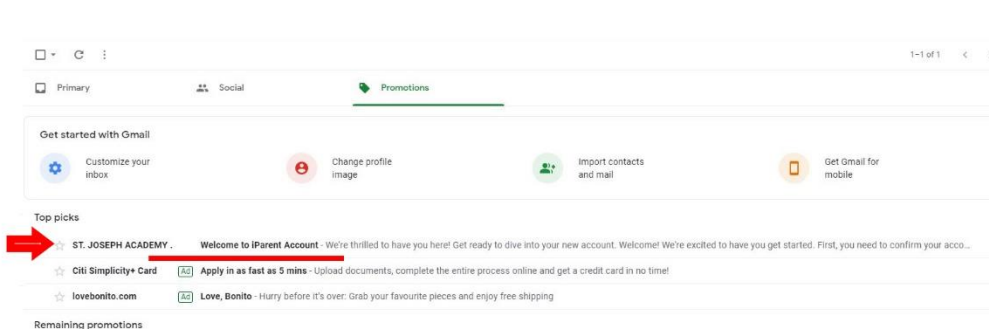

## STEP 4: Verify your registration by clicking Activate Your Account.

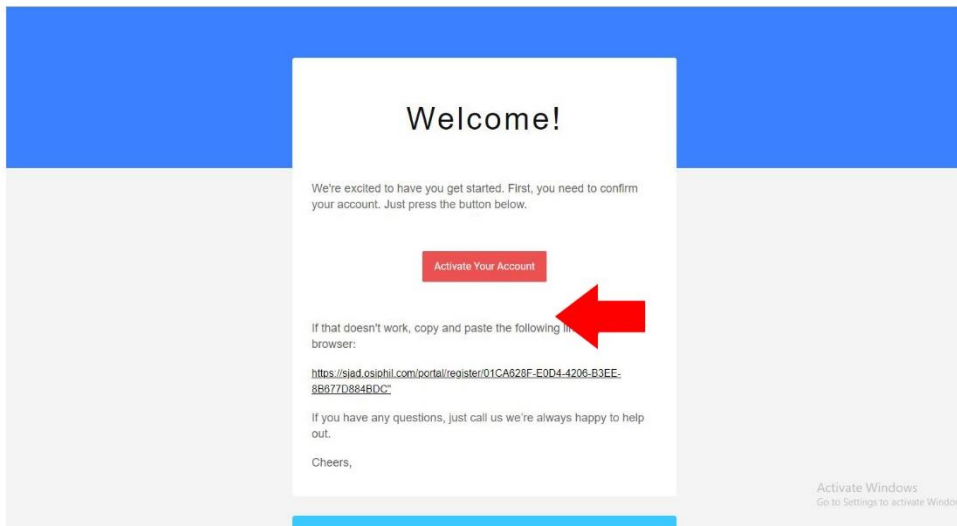

## STEP 5: Login using your email as your username then type your password.

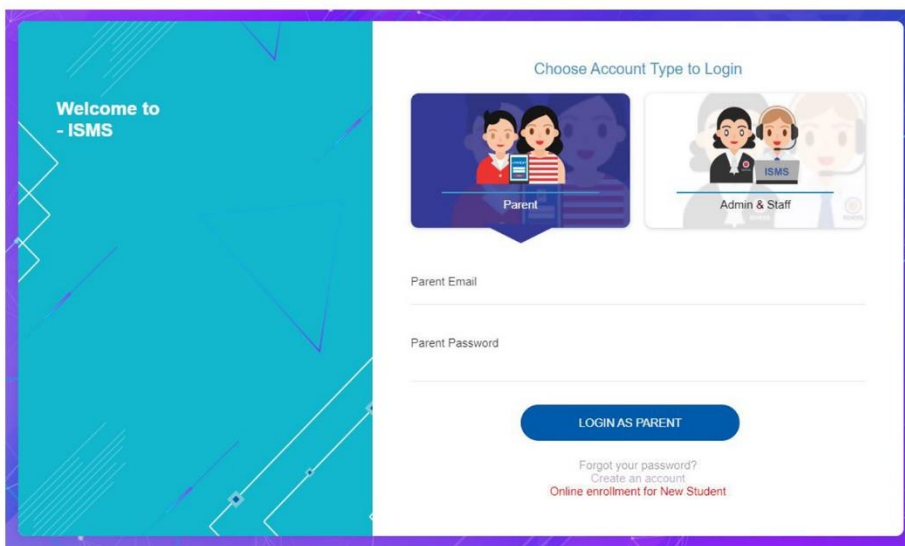

To view your child's enrollment status, click View Application Status.  
**\*\*Note: Make sure you select the correct school year.**

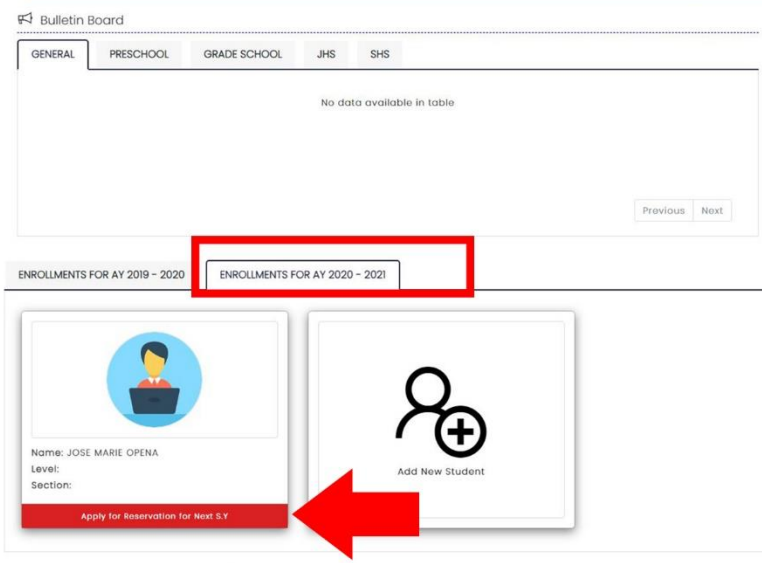

**NOTE:**  
if your child's name does not appear in the dashboard, please contact the Registrar's Office to update your email.

Select Active Student then the branch and the level you wish to apply.

Then Select the button Apply Now.

Academic Year 2020 - 2021

APPLICATION PROCESS

Would you like to apply for the Academic Year 2020 - 2021?

Active Student

Cavite Branch

Grade 6

Apply Now

To complete enrollment, please comply with two (2) steps below:

1. Select your desired payment plan.

2. Upload proof of payment and wait for the Administrator to confirm payment.

Back to Parent Dashboard

Academic Year 2020 - 2021

APPLICATION PROCESS

1

Select Payment Plan

Plan A

Upload

Action Required

2

Pay Enrollment/Tuition Fee

Josie Paner

Application Status

Student Profile

Parent

Address & Emergency Info

School History

Activate Windows  
Go to Settings to activate Windows.

Once the payment is reflected, your child is already enrolled!